

UPR Installation Instructions

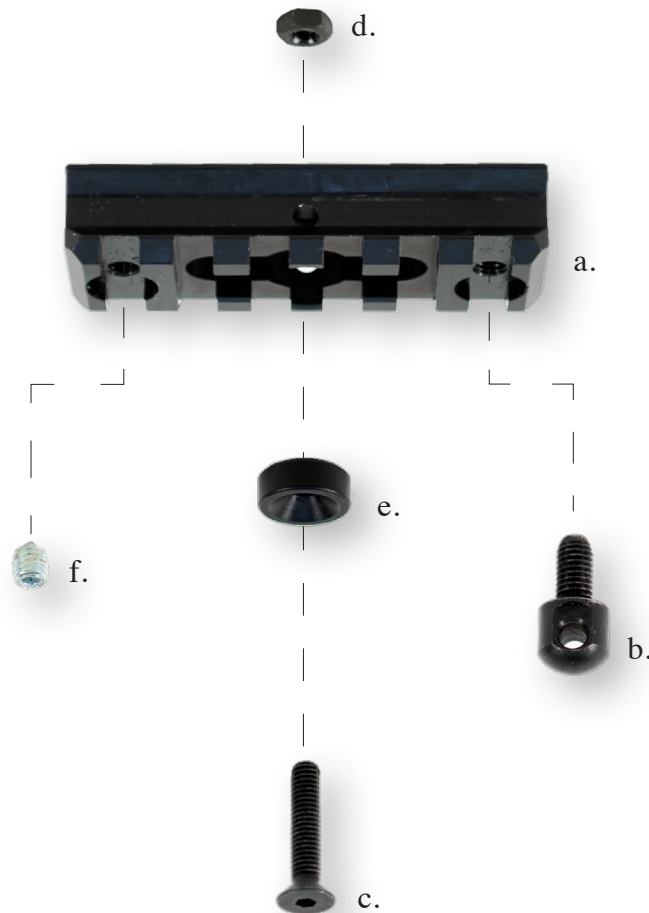

Parts List:

- a. UPR body
- b. Sling Swivel Stud
- c. Counter Sunk Allen head screw
- d. Nut
- e. Counter sunk washer
- f. Allen head set screw
- g. Allen Wrench

Always make sure the firearm is unloaded before installing this product.

The UPR replaces the existing sling swivel stud on the forend of the firearm.

- 1) Remove the existing sling swivel stud on the forend. (This may require removal of the stock from barreled action)
- 2) Insert the counter sunk washer into the center of the UPR body from the Picatinny rail side with the counter sunk visible as you look at the Picatinny rail.
- 3) Insert the counter sunk screw into the counter sunk washer.
- 4) Insert the UPR body, counter sunk washer and counter sunk screw assembly into the existing sling swivel stud hole.
- 5) Attach the nut to the counter sunk screw and hand tighten.
- 6) There are 2 additional threaded holes on either end of the Picatinny rail on the UPR body. One hole is for the sling swivel stud and the other hole is for the Allen Head set screw to take up any space between the contour of the stock and the UPR body.
- 7) After the Sling Swivel stud and the set screw have been tightened down securely, tighten the counter sunk screw and nut to secure the UPR body in place.
- 8) Reattach the stock to the barreled action if necessary.